

COMMUNITY EQUESTRIAN CENTER / FAHNESTOCK RANCH

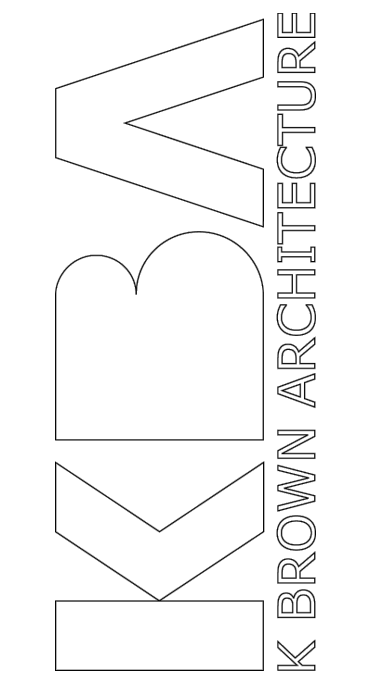

FIRE NOTES:

- FIRE DEPARTMENT VEHICULAR ACCESS ROADS MUST BE INSTALLED AND MAINTAINED IN A SERVICEABLE MANNER PRIOR TO AND DURING THE TIME OF CONSTRUCTION. FIRE CODE 501.4
- BUILDING ADDRESS NUMBERS SHALL BE PROVIDED AND MAINTAINED SO AS TO BE PLAINLY VISIBLE AND LEGIBLE FROM THE STREET FRONTING THE PROPERTY. NUMBERS SHALL CONTRAST WITH BACKGROUND, BE ARABIC OR ALPHABETICAL LETTERS, AND BE A MINIMUM OF 4" HIGH WITH A MINIMUM STROKE OF 1/4", CRC R314.1
- THE REQUIRED FIRE FLOW FOR HYDRANTS IS 1500 GPM, AT 20 PSI RESIDUAL PRESSURE, FOR DURATION OF 1 HOUR OVER AND ABOVE MAXIMUM DAILY DOMESTIC DEMAND. FIRE CODE 501.3 AND APPENDIX B TABLE B105.(1) AND (2)
- THERE ARE NO OVERHEAD HIGH VOLTAGE TRANSMISSION LINES OR DRIP LINES WITHIN 100 FEET OF THIS PROPERTY.
- HOUSEHOLD FIRE ALARM SYSTEMS INSTALLED IN ACCORDANCE WITH NFPA 72 THAT INCLUDE SMOKE ALARMS, OR A COMBINATION OF SMOKE DETECTOR AND AUDIBLE NOTIFICATION DEVICE INSTALLED AS REQUIRED BY THIS SECTION FOR SMOKE ALARMS, SHALL BE PERMITTED. THE HOUSEHOLD FIRE ALARM SYSTEM SHALL PROVIDE THE SAME LEVEL OF SMOKE DETECTION AND ALARM AS REQUIRED BY THIS SECTION FOR SMOKE ALARMS. WHERE A HOUSEHOLD FIRE WARNING SYSTEM IS INSTALLED USING A COMBINATION OF SMOKE DETECTOR AND AUDIBLE NOTIFICATION DEVICE, IT SHALL BECOME A PERMANENT FIXTURE OF THE OCCUPANCY AND OWNED BY THE HOMEOWNER. THE SYSTEM SHALL BE MONITORED BY AN APPROVED SUPERVISING STATION AND BE MAINTAINED IN ACCORDANCE WITH NFPA 72. RESIDENTIAL CODE R314.2
- SMOKE ALARMS SHALL RECEIVE THEIR PRIMARY POWER FROM THE BUILDING WIRING PROVIDED THAT SUCH WIRING IS SERVED FROM A COMMERCIAL SOURCE AND SHALL BE EQUIPPED WITH A BATTERY BACKUP. RESIDENTIAL CODE R314.5
- WHERE MORE THAN ONE SMOKE ALARM IS REQUIRED TO BE INSTALLED WITHIN AN INDIVIDUAL DWELLING OR SLEEPING UNIT, THE SMOKE ALARMS SHALL BE INTERCONNECTED IN SUCH A MANNER THAT THE ACTIVATION OF ONE ALARM WILL ACTIVATE ALL OF THE ALARMS IN THE INDIVIDUAL UNIT. RESIDENTIAL CODE R314.5
- AN APPROVED CARBON MONOXIDE ALARM SHALL BE INSTALLED IN DWELLING UNITS AND IN SLEEPING UNITS WITHIN WHICH FUEL-BURNING APPLIANCES ARE INSTALLED AND IN DWELLING UNITS THAT HAVE ATTACHED GARAGES. REQUIRED CARBON MONOXIDE ALARMS SHALL RECEIVE THEIR PRIMARY POWER FROM THE BUILDING WIRING WHERE SUCH WIRING IS SERVED FROM A COMMERCIAL SOURCE AND SHALL BE EQUIPPED WITH A BATTERY BACK-UP. WHERE MORE THAN ONE CARBON MONOXIDE ALARM IS REQUIRED TO BE INSTALLED WITHIN THE DWELLING UNIT OR WITHIN A SLEEPING UNIT THE ALARM SHALL BE INTERCONNECTED IN A MANNER THAT ACTIVATION OF ONE ALARM SHALL ACTIVATE ALL OF THE ALARMS IN THE INDIVIDUAL UNIT. RESIDENTIAL CODE R314.5.1.2, BUILDING CODE 420.4.1
- ALL FIRE HYDRANTS SHALL MEASURE 6" X 4" X 2 1/2", BRASS OR BRONZE, CONFORMING TO AMERICAN WATER WORKS ASSOCIATION STANDARD C503, OR APPROVED EQUAL, AND SHALL BE INSTALLED IN ACCORDANCE WITH THE COUNTY OF LOS ANGELES FIRE DEPARTMENT REGULATION 8.
- AN APPROVED KEY BOX, LISTED IN ACCORDANCE WITH UL1031 SHALL BE PROVIDED AT THE LOCATION DETERMINED BY THE FIRE INSPECTOR, FIRE CODE 506.

NPDES FORM:

- ERODED SEDIMENTS AND OTHER POLLUTANTS MUST BE RETAINED ON SITE AND MAY NOT BE TRANSPORTED FROM THE SITE VIA SHEET FLOW, SWALES, AREA DRAINS, NATURAL DRAINAGE COURSES OR WIND.
- STOCKPILES OF EARTH AND OTHER CONSTRUCTION RELATED MATERIALS MUST BE PROTECTED FROM BEING TRANSPORTED FROM THE SITE BY THE FORCED OF WIND OR WATER.
- FUELS, OILS, SOLVENTS AND OTHER TOXIC MATERIALS MUST BE STORED IN ACCORDANCE WITH THEIR LISTINGS AND ARE NOT TO CONTAMINATE THE SOIL AND SURFACE WATERS. ALL APPROVED STORAGE CONTAINERS ARE TO BE PROTECTED FROM THE WEATHER, SPILLS MAY NOT BE WASHED INTO THE DRAINAGE SYSTEM.
- NON-STORM WATER RUNOFF FROM EQUIPMENT AND VEHICLE WASHING AND ANY OTHER ACTIVITY SHALL BE CONTAINED AT THE PROJECT SITE.
- EXCESS OR WASTE CONCRETE MAY NOT BE WASHED INTO THE EXCESS OR WASTE CONCRETE MAY NOT BE WASHED INTO THE PUBLIC WAY OR ANY OTHER DRAINAGE SYSTEM. PROVISIONS SHALL BE MADE TO RETAIN CONCRETE WASTES ON SITE UNTIL THEY CAN BE DISPOSED OF AS SOLID WASTE.
- TRASH AND CONSTRUCTION RELATED SOLID WASTE MUST BE DEPOSITED INTO COVERED RECEPTACLE TO PREVENT CONTAMINATION OF RAINWATER AND DISPERSAL BY WIND.
- SEDIMENTS AND OTHER MATERIALS MAY NOT BE TRACKED FROM THE SITE BY VEHICLE TRAFFIC. THE CONSTRUCTION ENTRANCE ROADWAYS MUST BE STABILIZED SO AS TO INHIBIT SEDIMENTS FROM BEING DEPOSITED IN THE PUBLIC WAY. ACCIDENTAL DEPOSITIONS MUST BE SWEEP UP IMMEDIATELY AND MAY NOT BE WASHED DOWN BY RAIN OR OTHER MEANS.
- ANY SLOPES WITH DISTURBED SOILS OR DENIVED OF VEGETATION MUST BE STABILIZED SO AS TO INHIBIT EROSION BY WIND AND WATER.
- ANY REQUIREMENTS SET FORTH BY THE INSPECTOR.
- AS THE PROJECT OWNER OR AUTHORIZED AGENT OF THE OWNER, I HAVE READ AND UNDERSTAND THE REQUIREMENTS LISTED ABOVE NECESSARY TO CONTROL STORM WATER POLLUTION FROM SEDIMENTS, EROSION, AND CONSTRUCTION MATERIALS, AND I CERTIFY THAT I WILL COMPLY WITH THESE REQUIREMENTS.

PRINT NAME _____
(OWNER OR AUTHORIZED AGENT OF OWNER)

SIGNATURE _____ DATE _____
(OWNER OR AUTHORIZED AGENT OF OWNER)

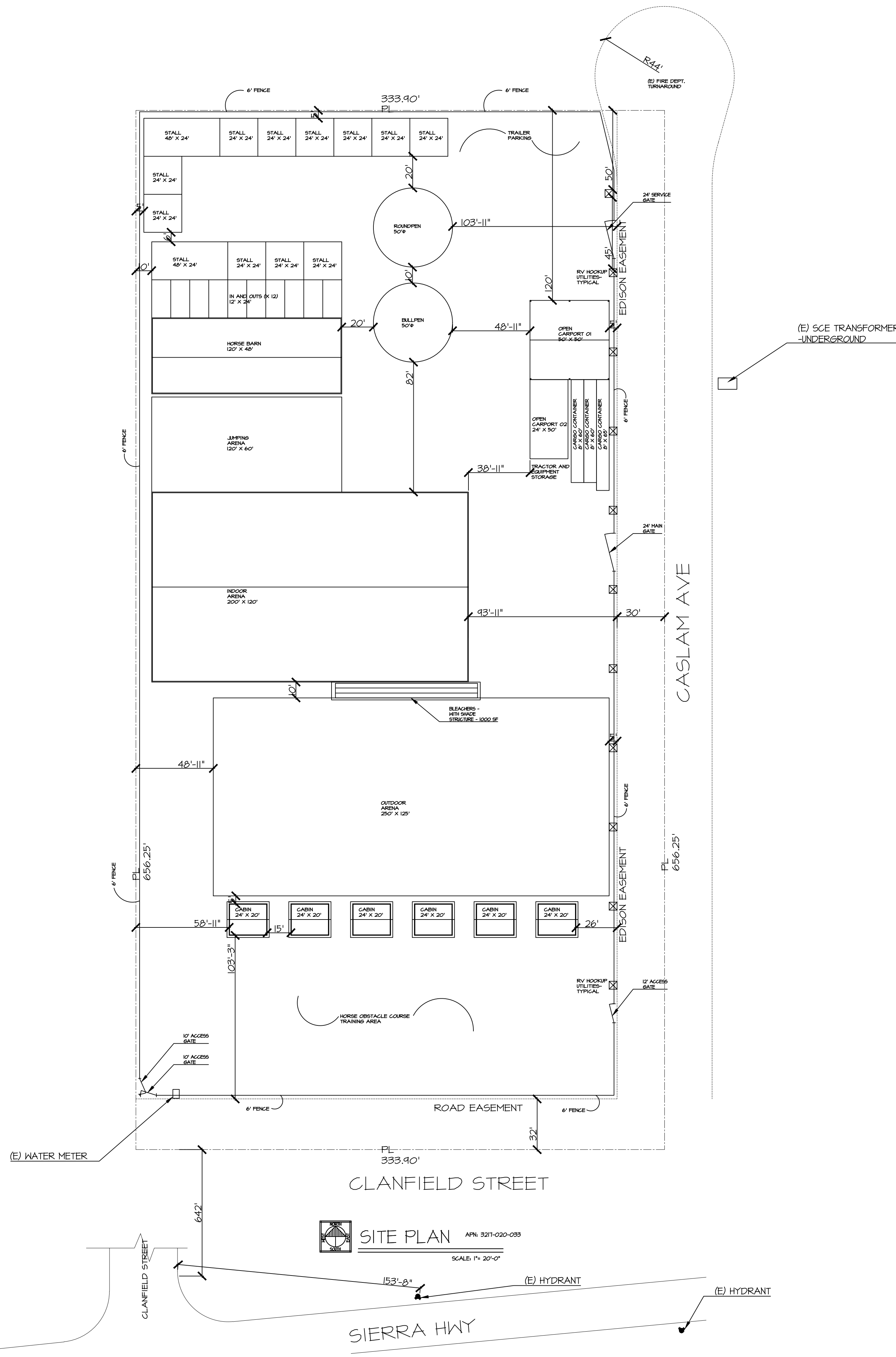
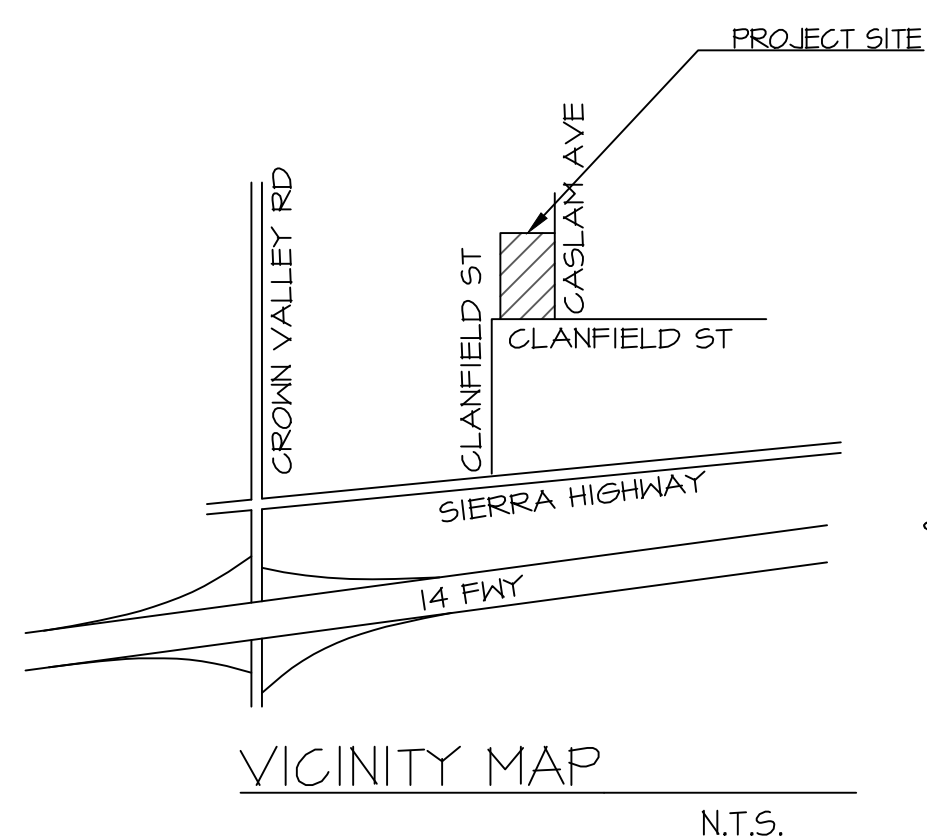

COUNTY OF LOS ANGELES

APPLICABLE CODES

- | | |
|---------------------------------|-----------------------------|
| 2023 CALIFORNIA BUILDING CODE | 2023 CALIFORNIA ENERGY CODE |
| 2023 CALIFORNIA MECHANICAL CODE | 2023 LA COUNTY FIRE CODE |
| 2023 CALIFORNIA ELECTRICAL CODE | |
| 2023 CALIFORNIA PLUMBING CODE | |

JURISDICTIONS

- | | |
|----------------------------------|--|
| COUNTY OF LA BUILDING DEPARTMENT | LOS ANGELES COUNTY FIRE DEPARTMENT & HEALTH DEPARTMENT |
| PLANNING DEPARTMENT | |
| DRAINAGE | |

SCOPE OF WORK

- COMMUNITY EQUESTRIAN CENTER AND HORSE RESCUE SITE
- HORSE STALLS (X 13)
 - VARIOUS OUTDOOR ARENAS
 - 5,160 SF HORSE BARN (18 STALL)
 - 2,500 SF OPEN CARPORT 01
 - 1,200 SF OPEN CARPORT 02
 - 24,000 SF INDOOR ARENA
 - 520 SF STORAGE CONTAINER
 - 480 SF STORAGE CONTAINER (X 2)
 - 480 SF CABIN (X 6)
 - RV UTILITY HOOK UPS (X 11)
 - 1,000 SF BLEACHER SHADE STRUCTURE

SITE DATA

APN: 321T-020-033
ADDRESS: 33851 CASLAM AVE
ACTON, CA 93510
LOT SIZE: 5 ACRES // 219,122 SF
FIRE ZONE: VHFH5Z

BUILDING DESCRIPTION

- 5,160 S.F., 1 STORY HORSE BARN
FIRE SPRINKLERS: NO
USE: AGRICULTURE
OCCUPANCY: U PER CHAPTER 3 CBC
TYPE OF CONSTRUCTION III-B PER CHAPTER 6, CBC 2023
- 2,500 S.F., 1 STORY OPEN CARPORT 01
FIRE SPRINKLERS: NO
USE: AGRICULTURE
OCCUPANCY: U PER CHAPTER 3 CBC
TYPE OF CONSTRUCTION IV PER CHAPTER 6, CBC 2023
- 24,000 S.F., 1 STORY INDOOR ARENA
FIRE SPRINKLERS: NO
USE: AGRICULTURE
OCCUPANCY: U PER CHAPTER 3 CBC
TYPE OF CONSTRUCTION III-B PER CHAPTER 6, CBC 2023
- 520 S.F., 1 STORY STORAGE CONTAINER (AG ACCESSORY)
FIRE SPRINKLERS: NO
USE: AGRICULTURE
OCCUPANCY: U PER CHAPTER 3 CBC
TYPE OF CONSTRUCTION I-A PER CHAPTER 6, CBC 2023
- 480 S.F., 1 STORY CABIN
FIRE SPRINKLERS: NO
USE: RESIDENTIAL
OCCUPANCY: R-3 PER CHAPTER 3 CBC
TYPE OF CONSTRUCTION V-B PER CHAPTER 6, CBC 2023
- 1,200 S.F., 1 STORY OPEN CARPORT 02
FIRE SPRINKLERS: NO
USE: UNOCCUPIED
OCCUPANCY: U PER CHAPTER 3 CBC
TYPE OF CONSTRUCTION IV PER CHAPTER 6, CBC 2023
- 1,000 S.F., 1 STORY BLEACH SHADE STRUCTURE
FIRE SPRINKLERS: NO
USE: UNOCCUPIED
OCCUPANCY: U PER CHAPTER 3 CBC
TYPE OF CONSTRUCTION III-B PER CHAPTER 6, CBC 2023

DEFERRED SUBMITTALS:

- INDIVIDUAL BUILDING PERMITS FOR ALL STRUCTURES

DESIGN TEAM:

| | |
|---|---|
| OWNER: MICHAEL FAHNESTOCK 323-834-1314 MRMICHAEL007@GMAIL.COM | ARCHITECT: K BROWN ARCHITECTURE 754 WEST LANCASTER BLVD LANCASTER, CA 93534 661-213-9480 KENTONBROWN@KBROWNARCH.COM |
|---|---|

SHEET INDEX:
A-1.0 COVER SHEET & SITE PLAN

COPYWRITE

THESE DRAWINGS AND SPECIFICATIONS AS INSTRUMENTS OF SERVICE REMAIN THE PROPERTY OF K BROWN ARCHITECTURE AND SHALL NOT BE USED FOR ANY OTHER PURPOSE OTHER THAN THOSE FOR WHICH THEY HAVE BEEN SUPPLIED OR PREPARED. THESE DRAWINGS SHALL NOT BE REPRODUCED, COPIED, OR TRACED WITHOUT THE EXPRESSED WRITTEN CONSENT OF THE ARCHITECT. COPYRIGHT 2024 K BROWN ARCHITECTURE

STAMP

PROJECT INFO.

COMMUNITY EQUESTRIAN CTR./FAHNESTOCK
ADDRESS: 33851 CASLAM AVE
ACTON, CA 93510
323-839-7374

ISSUE DATES

| | | |
|---|---|---|
| 1 | x | x |
| . | . | . |
| . | . | . |
| . | . | . |
| . | . | . |

PROJECT NO.

: 24-071

DRAWN BY

: KB

SHEET TITLE

SITE PLAN
COVER

SHEET NO.

A-1.0